

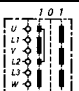
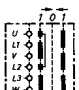

Motorschalter
Motor switches

Schaltbild Circuit diagram	Bemessungsdauerstrom I _u Rated permanent current I _u	Max. Schaltleistung Max. switching capacity		
			IP 54 Fußschalter Foot-operated switch	
	A	AC-3/400 V KW	Typ Type	Best.-Nr. Ref. No.
	25	11 kW	WBF	151 306
	Wendescharter Reversing switch			
	10	AC-4/400 V 3 kW	WBFT	151 307
	Wendescharter – Tastend Reversing switch – Key switching			

Steuerschalter –
Befehlsgeräte
Control switches –
Master units

Schaltbild Circuit diagram	Bemessungsdauerstrom I _u Rated permanent current I _u	Max. Schaltleistung Max. switching capacity		
			Fußschalter Alu-Druckguss flach Foot-operated switch alu cast flat-type	
	A	AC-15/230 V A	Typ Type	Best.-Nr. Ref. No.
2 Schließer 2 NO	10	6	TF 2S	141 321
	Ein-Ausschalter, 2-polig, 2 Schließer – Tastend On-off switch, 2 poles, 2 NO – Key switching			
1 Schließer/1 Öffner 1 NO/1 NC	10	6	TF6	141 311
	1 Schließer/1 Öffner - Tastend Change-over switch 1 NO/1 NC – Key switching			

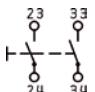
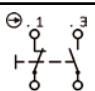
Maßzeichnungen Seite 173
Dimensions page 173

Fußschalter TF/WBF 1-pedalig

Foot-operated switches TF/WBF one-pedal

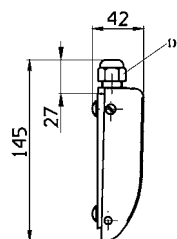
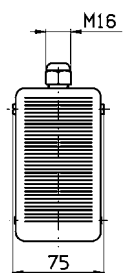

Typ	Type
TF1S/1Ö, TF2S, TF6	

Maße in mm
Dimensions in mm

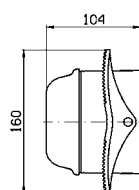
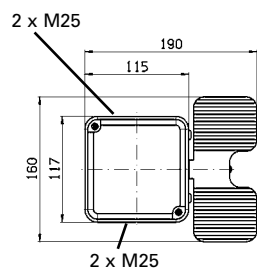

Bohrbild Drilling
Boden Bottom

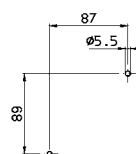

Typ	Type
WBF, WBFT	

1) Verschraubung im Lieferumfang enthalten.
Screws included in the delivery.